

# ProFace X [TD]

## Face & Palm Verification and Body Temperature Detection Terminal



**ProFace X [TD]** is a fully upgraded version of the ProFace product line, which is designed to deal with all kinds of scenarios. Powered by the ZKTeco-customized CPU for running the intellectualized engineering facial recognition algorithm and the latest computer vision technology, ProFace X [TD] supports both facial and palm verification with large capacity and rapid recognition speed, boosting the security performance in all aspects.

ProFace X [TD] also helps eliminate hygiene concerns; not only because of the contactless recognition technology it is equipped with, but also because of the new functions namely body temperature detection and masked individual identification.

The facial recognition capability has reached a new height in the biometrics technology industry with a maximum of 50,000 facial templates, recognition speed of less than 0.3 sec per face, and ultimate anti-spoofing ability against almost all types of fake photos and videos attack.

In addition, the 3-in-1 palm recognition (Palm Shape, Palm Print and Palm Vein) is performed in 0.35 sec per hand; the palm data acquired will be compared with a maximum of 5,000 palm templates.

As mentioned above, ProFace X [TD] can assist in reducing the risk of infection and germs spreading during the recent global public health issue as well. The enables fast and accurate body temperature measurement and masked individual identification during facial and palm verification at all access points, especially in hospitals, factories, schools, commercial buildings, airports, stations, and other public areas.

\* **NOTE:** Palm verification is customized for customers.

## Features

- Ultra-large capacity of facial templates for 1:N verification: 30,000 (standard); max. 50,000 (optional)
- Huge capacity of palm templates; 1:N - 5,000 palm templates (customized)
- Anti-spoofing algorithm against print attack (laser, color and B/W photos), videos attack, and 3D mask attack
- Intelligent energy-saving design; precisely evaluation of the distance (up to 2.5m (8.2ft)) between the user and the device by a microwave detector before waking up the recognition terminal
- 2MP starlight CMOS sensor camera with WDR function
- 8" touch screen with 400 lux, which offers high visibility under strong and direct light
- Wide range of working temperature (16°C ~ 32°C; 60.8°F ~ 89.6°F)
- Body temperature detection: measurement deviation of  $\pm 0.3^{\circ}\text{C}$ ; measurement distance of 30 – 50cm
- Mask detection; facial verification available with masks

\* Facial verification for masked individuals will increase FAR. Palm verification for masked individuals is recommended.

Temperature measurement data is for reference only, not for medical use.

ProFace X [TD] is available for indoor environments without wind or direct sunlight.

## Specifications (G: GL Exclusive Feature)

Capacity	Access Control Interface	Communication
<span>G</span> Faces	Lock Relay Output	TCP/IP
	Alarm Output / Auxiliary Input	Wiegand Input / Output
Palm	Exit Button / Door Sensor	Wi-Fi (Optional)
Users		RS485 / RS232*
<span>G</span> Transactions		
User Photos		
Event Photos		
Compatibility	Special Functions	Additional Info
Security Relay Box	<span>G</span> 0.3s High Speed Facial Verification	Face Algorithm: ZKLiveFace5.8
Wiegand / RS485 Slave Reader	Liveness Detection	Palm: FAR $\leq 0.01\%$ ; FRR $\leq 1\%$ (Customized)
with FP / RFID / Barcode / QR-code	HTTPS Communication Encryption (Optional)	Working Temperature: 16°C ~ 32°C,
ZKBioSecurity Software	<span>G</span> Event Snapshot	(60.8°F ~ 89.6°F)
		Working Humidity: $\leq 93\%$
		Storage Temperature: -40°C ~ 65°C
		(-40°F ~ 149°F)
		Storage Humidity: $\leq 93\%$
		Net Weight: 853g
		Dimensions (H*L*D): 227*143*26.1mm
Hardware	Standard Functions:	Power
900MHz Dual Core Customized	Access Levels, Groups, Holidays, DST,	Operating Voltage: 12V DC
Computer vision CPU	Duress Mode (Password), Anti-Passback,	Current Draw: < 2,000mA
<span>G</span> 512MB RAM / 8G Flash	Record Query, Tamper Switch Alarm,	
<span>G</span> 8" High light (400lux) IPS Touch LCD	Custom Wallpaper & Screen Saver	
<span>G</span> 2MP WDR Low Light Camera		
Adjustable Light brightness LED		
Hi-Fi Voice		
High Sensitivity Microphone		
Distance Detection Sensor		
Reset Button and Tamper Switch		

\* Note: RS232 is for external printer and RS485 is for RS485 readers.

## Configuration

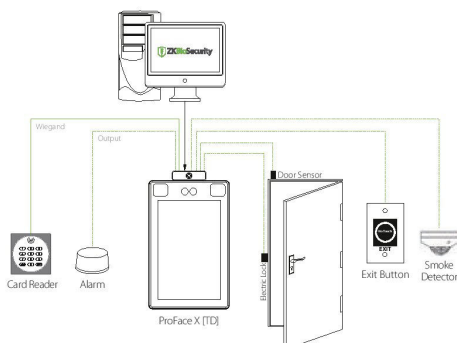

## Dimensions (mm)

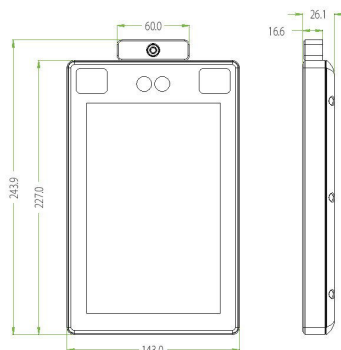

ZKTECO CO., LTD.

www.zkteco.com

E-mail: sales@zkteco.com

Copyright©2024 ZKTECO CO., LTD. All rights reserved.  
V2.2 01/04/2024